



For smooth insertion

## EyeOL INJECTOR & CARTRIDGE

Single use Injection System for Foldable IOL's

### Instructions for Use

- Description:  
One Single use injector packed in a sterile pouch.  
One Single use cartridge packed in a sterile pouch.
- Indication for use :  
The Injector & Cartridge set is used to fold and insert a foldable Intra Ocular Lens into the eye.



Open the cartridge wings and carefully inject visco elastic solution ensuring no bubbles get entrapped in the cartridge lumen

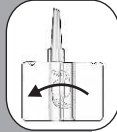

Place the IOL on the cartridge ensuring that the whole lens is seated in the groove of the open wings as per illustration



Shut the wings while taking care that no part of the lens gets trapped between the wings. Visually confirm this.

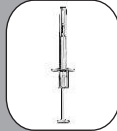

Remove injector from the pouch and visually inspect the same. Ensure smooth movement of the plunger.

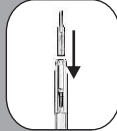

Align the back of the cartridge with the injector mouth and press in firmly till it locks in place.



Once the cartridge locks in place, visually check if the silicon tip of the plunger is aligned with the orifice of the cartridge . A port has been provided to visualize this.



Gently press the plunger without using excessive force till the lens is inside the lumen. The use of excessive force can be an indication of the lens being trapped between the cartridge wings or the injector tip has overridden the lens. If this happens do not proceed further. Now enter the eye and press the plunger till the lens comes out fully & disengages from the cartridge.

STERILE EO



CE  
0473

*eyeol*

#### EYEOL U.K. LIMITED

8 Apex Business Centre,  
Boscombe Road, Dunstable,  
Bedfordshire LU5 4SB, U.K.  
Fax: +44 (0) 1582 607009  
Phone: +44 (0) 1582 477002  
Email: sales-eyeol@btconnect.com,  
eyeoluk@gmail.com  
Web: www.eyeol.co.uk